

Emergency Preparedness

Jeff Edwards

Community Emergency Management Coordinator

Township of Assiginack

ASSIGINACK STRONG



Assiginack's EM Program

Follows requirements under the Emergency Management and Civil Protection Act, such as:

- CEMC
- EM Committee
- ERP
- HIRA
- CI Listing
- Pub Ed program
- Emergency Control Group
- Training
- Exercise



Assiginack's EM Program

GOES BEYOND EMCPA requirements:

- Evacuation Plan
- Generator Plan
- Hazard Specific Plans
- Pandemic Plan
- Emergency Information Plan
- Emergency Telecommunications Plan
- Recovery Plan
- Business Continuity Plan
- Uses Components of IMS

**HOPE IS
NOT
A PLAN**

How we respond to an emergency

Definition

A situation or an impending situation that constitutes a danger of major proportions that could result in serious harm to persons or substantial damage to property and that is caused by the forces of nature, a disease or other health risk, an accident or an act whether intentional or otherwise



How we respond to an emergency

Something happens – appropriate responders attend to the scene.

Authority Having Jurisdiction (AHJ) at the scene determines what to do.

If beyond local capabilities or there will be impacts outside of the immediate site, AHJ contacts the Township's CAO to recommend gathering the Municipal Emergency Control Group together.

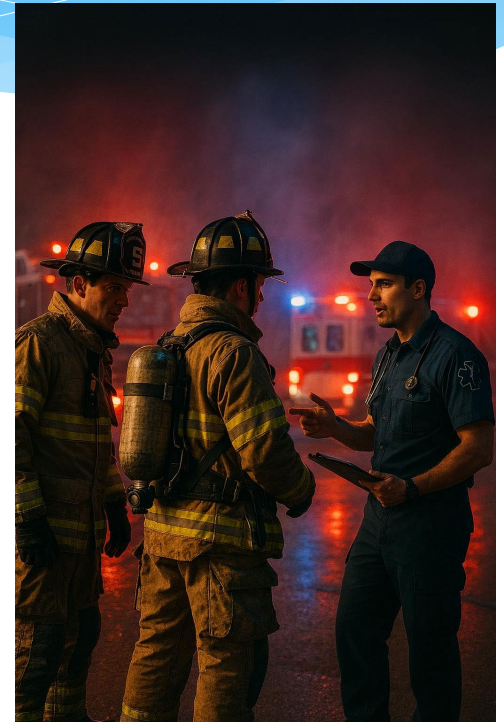

How we respond to an emergency

MECG includes:

Mayor

CAO

Fire Chief

OPP

Public Works

Led by CAO

CEMC

EIO

Health Unit

EMS

Other agencies as
required



How we respond to an emergency



MECG determines:

- Need to declare an emergency;
- What support can be provided to the site;
- What support needs to be provided to remainder of community;
- What resources and assistance is required;
- What municipal services will be impacted and how to maintain services;
- Evacuation management;
- Messaging to the public.

How we respond to an emergency

Declaration of Emergency

Can only be done by Mayor

OPP, council, Fire Chief, CAO, MPP,
cannot declare.

Mayor makes the decision on
advice of the MECCG.

Does not = funding \$\$\$\$



**DECLARE
EMERGENCY**

How we respond to an emergency

Opening reception centres, shelters, cooling/heating centres

- ❖ **When it is safe to do so – for staff and for the public.**
- ❖ **When other priorities are managed.**
- ❖ **Number of people needing shelter justifies opening it.**
- ❖ **Not immediately at the start of an event.**

How you can be prepared!

- * Every level of government expects you to be prepared for a minimum of 72 hours, including:
 - Heating/cooling;
 - Communications;
 - Power/Hydro;
 - Medications;
 - Food;
 - Etc.



72 Hour Emergency Kit

- * Crank Flashlight
- * Crank radio
- * Spare batteries (for radio and flashlight if not crank style)
- * First-Aid Kit
- * Extra car keys and cash
- * Important papers (identification, house insurance)



72 Hour Emergency Kit

- * Whistle (to attract attention, if needed)
- * Playing cards, games
- * Prescription/Reading Glasses
- * Baby Items
- * Candles & Matches/lighter*
- * Backpack/duffel bag (to hold all of the 72-hour emergency kit items)



Family Emergency Plan

- * Where to go if evacuated
 - * Safe place that will likely not be affected by the disaster
- * Who to call
 - * A relative or friend that can be reached during a disaster
- * What to bring when evacuated
 - * 72 hour emergency kit, cell phone



Family Emergency Plan

- * Show family members how to turn off the water, electricity and gas, and drain the water system
- * Show family members the location of and how to use a fire extinguisher
- * Check the contents of your emergency kits regularly
- * Learn first aid and CPR
- * Family members with special needs
- * Plan for your pets

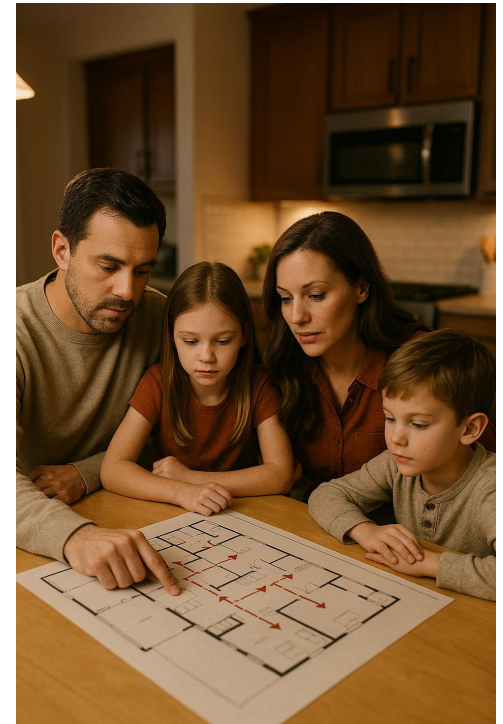

Pets

- * Most people will not evacuate without pets
- * Most evacuation centres will not allow pets
- * Kit for pets:
 - * Leash
 - * Crate
 - * Food and water
 - * Toy or something familiar
 - * Cleaning supplies



Car Kit

- * Prepare a smaller survival kit for your car
- * Keep the tank at least $\frac{1}{2}$ full
- * Do not leave car idling for long periods of time



Disaster Tips

- * Water in your basement
 - * It backed up through the sewer system
 - * If the water is clean, do not pump it out until your neighbours can pump theirs out at the same time.
 - * Pump it out slowly – 1 foot/hr
 - * Shut off electricity with a dry piece of wood
- * Do not use a barbeque in your home
- * Do not plug a generator directly into your home
- * Text Messaging

Questions?

<http://www.getprepared.gc.ca> – Information on personal and family preparedness

<http://www.emergencymanagementontario.ca/english/home.html> - Information on Public Alerting, Family Emergency Planning and emergencies in Ontario

<http://www.redcross.ca/how-we-help/emergencies-and-disasters-in-canada/be-ready-app> - Emergency Preparedness App

Jeff Edwards
Community Emergency Management Coordinator
Township of Assiginack